

4

ACTUATORS

M604C, M904E/F, M931A



- **Name** Modutrol Motors
 - **Input** Potentiometer, relay
 - **Control** 2-position, floating, proportional
- Page **▶ 4-2**

M931F



- **Name** Modutrol Motor
 - **Input** Relay contact
 - **Control** Damper, butterfly, valve
- Page **▶ 4-3**

ECM3000



- **Name** Control Motor
 - **Input** Relay contact, 4 to 20mAdc, potentiometer
 - **Rotating angle** 0 to 90°C/160°C
- Page **▶ 4-4**

MY940



- **Name** High Torque Actuator
 - **Input** Potentiometer
 - **Control** ON/OFF, position proportional
- Page **▶ 4-5**

HM



- **Name** High-torque Motor
 - **Input** 4 to 20mAdc
 - **Control** 2-position, proportional
- Page **▶ 4-6**

PGM10N/F



- **Name** Solid State Relays
 - **Range** 3.5 to 30Vdc
 - **Control system** Zero-cross
- Page **▶ 4-7**

PGU410



- **Name** Power Gate Unit
 - **Input** 4 to 20mAdc
 - **Control system** Phase-controlled
- Page **▶ 4-8**

V5063A



- **Name** Single Seated Valve
 - **Application** Chilled/Hot water, steam
 - **Pressure** 980kPa max
- Page **▶ 4-9**

V5064A



- **Name** Double Seated Valve
 - **Application** Chilled/Hot water, steam
 - **Pressure** 980kPa max
- Page **▶ 4-10**

V5065A



- **Name** 3-way Mixing Valve
 - **Application** Chilled/Hot water
 - **Pressure** 980kPa max
- Page **▶ 4-11**

AT72-J1



- **Name** Transformer
 - **Primary** 100/200/220Vac
 - **Secondary** 25Vac
- Page **▶ 4-12**

ATY72Z



- **Name** Transformer
 - **Primary** 100/200/220Vac
 - **Secondary** 23Vac
- Page **▶ 4-13**

QN406B



- **Name** Auto/manual Switch
 - **Range** 0 to 100%
 - **Control system** Potentiometer
- Page **▶ 4-14**

Q631A/B



- **Name** Auxiliary Switches
 - **Operation** ON/OFF
 - **Output** Relay contact
- Page **▶ 4-15**

Q455C/D/F



- **Name** Valve Linkages
 - **Range** 9.5 to 38mm
 - **Control** Valve positioning
- Page **▶ 4-16**

Q605A/D/E

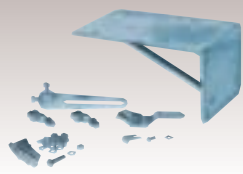

- **Name** Damper Linkages
 - **Used for** Modutrol Motor
 - **Function** Linkage for damper control
- Page **▶ 4-17**

CV3000 Alphaplus



- **Name** Control Valve
 - **Control** Fluid flow
 - **Used for** Process control
- Page **▶ 4-18**