

WEEKLY TIMER

Ordering information

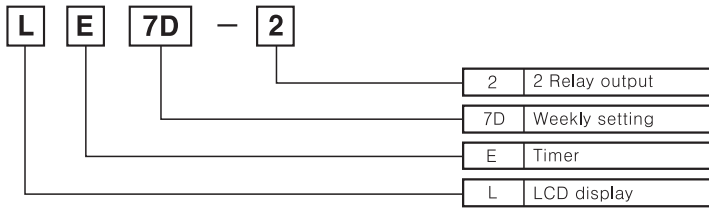

Features

- Individual programming of each day or each week.
- Included hardware for both panel and DIN rail mounting.
- When mounting base plate, DIN rail mounting is available.

Specifications

| Model | | LE7D-2 |
|--------------------------|------------------|--|
| Appearances & Dimensions | | [W72×H72×L60mm] |
| Power supply | | 100-240VAC 50/60Hz |
| Allowable voltage range | | 90 ~ 110% of power supply |
| Power consumption | | Approx. 3VA(240VAC 60Hz) |
| RETURN input | | Short-circuit or open by switch or relay |
| Timing program | | Programmable 24 Steps |
| Operation mode | | ON/OFF mode, Cycle mode, Pulse mode |
| Operation cycle | | 1 week(7days) |
| Mounting | | Front panel, Surface, DIN rail |
| Time deviation | | ±15sec/month(25℃) (±4sec/week) |
| Memory protection | | 5 years without power, 10 years with power applied |
| Control output | Contact type | Time-limit DPDT (2c) |
| | Contact capacity | 250VAC 5A resistive load |
| | Output number | Independent 2 output (1c × 2) |
| Relay life cycle | Mechanical | Min. 10,000,000 times |
| | Electrical | Min. 100,000 times(250VAC 5A resistive load) |

Front Panel identification

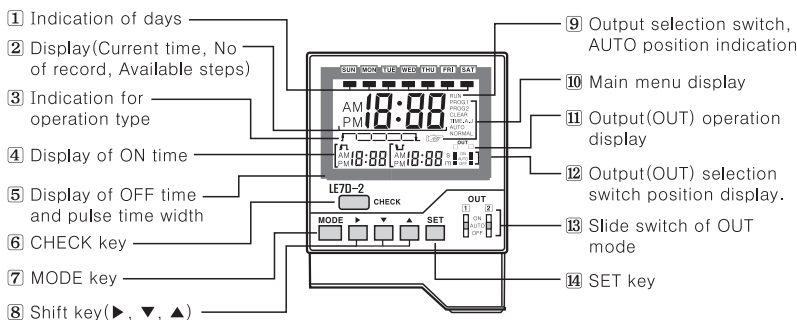

How to change the mounting type (Flash mounting surface mounting)

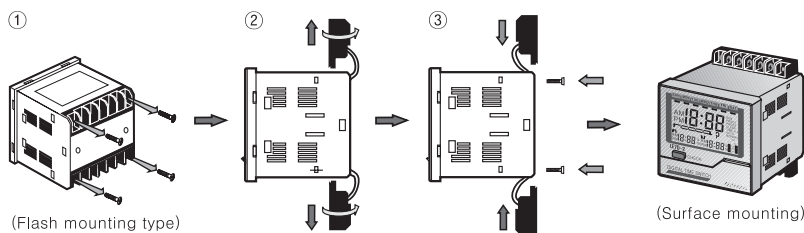

- ① Unscrew 4 bolts from terminal block.
- ② Detach terminal block from case and then rotate it 180°.
- ③ Assemble terminal block to case by using the 4 bolts.

Unit:mm

Connections

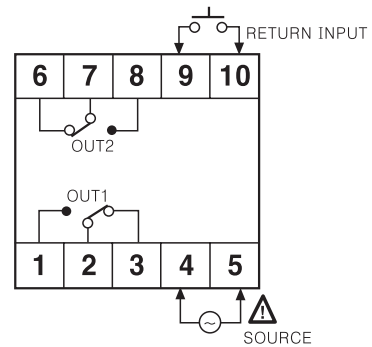

Mounting ON DIN Rail

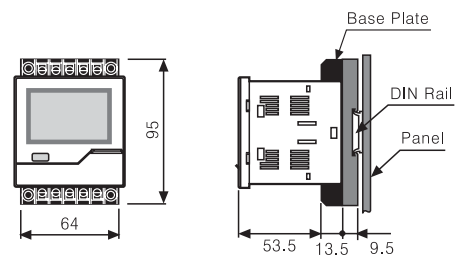

Unit:mm